



California State University Fullerton

# Evacuation Chair Locations



## Table of Contents

### College Park

1st Floor - Security Desk \_\_\_\_\_ 5

7th Floor - CP2 @ East Stairway; CP3 @ West Stairway \_\_\_\_\_ 6

### Computer Science

1st Floor - Near women's restroom 105 \_\_\_\_\_ 7

### Dan Black Hall

2nd Floor - DBH1 near men's restroom 205; DBH2 Stair one across from elevator \_\_\_\_\_ 8

### Education Classroom

Basement - Southwest stairway \_\_\_\_\_ 9

4th Floor - Across from 401 \_\_\_\_\_ 10

### Engineering

1st Floor - North stairway \_\_\_\_\_ 11

### Golleher Alumni House

2nd Floor - In room 205 up center stairs \_\_\_\_\_ 12

### Humanities

3rd Floor - East stairs by 329 \_\_\_\_\_ 13

6th Floor - East stairs by 629 \_\_\_\_\_ 14

### Kinesiology

Basement - Near room 010 \_\_\_\_\_ 15

2nd Floor - By stairway 3 (Near Room 260) \_\_\_\_\_ 16

**Langsdorf**

2nd floor - South lobby \_\_\_\_\_ 17

5th floor - West stairs \_\_\_\_\_ 18

**Library North**

1st Floor - On wall inside staff area \_\_\_\_\_ 19

Basement - by Stairway 1 \_\_\_\_\_ 20

**Library South**

4th Floor - PLS1 @ north stairway; PLS2 @ south stairway \_\_\_\_\_ 21

**McCarthy Hall**

3rd Floor - By center stairs \_\_\_\_\_ 22

Basement - By stair 2 (near room 51) \_\_\_\_\_ 23

**Mihaylo**

2nd Floor - SGMH2 by room 2406; SGMH1 by room 2504 \_\_\_\_\_ 24

4th Floor - SGMH3 in stairway 1; SGMH4 in stairway 4 \_\_\_\_\_ 25

**Performing Arts**

1st Floor - North entrance by Stair 1 near room 142 \_\_\_\_\_ 26

2nd Floor - By Stairway 7 (Near Room 296) \_\_\_\_\_ 27

**Titan Stadium Press Box**

2nd Floor - In stairway 1 (south) \_\_\_\_\_ 28

**Gordon Hall**

3rd Floor - south stairwell \_\_\_\_\_ 29

**Titan House**

Basement - Under spiral stairs \_\_\_\_\_ **30**

**Visual Arts Building D**

2nd Floor - Across from elevator \_\_\_\_\_ **31**

**Visual Arts Building E**

2nd Floor - near room 292 \_\_\_\_\_ **31**

Evacuation Chair =





## College park - 1st Floor



Chair # **CP1**

Location: **Security desk**

Style: **300-H**



## College park - 7th Floor



Chair # **CP2**

Location: **East stairway**

Style: **300-H**



Chair # **CP3**

Location: **West stairway**

Style: **300-H**

### Computer Science - 1st Floor

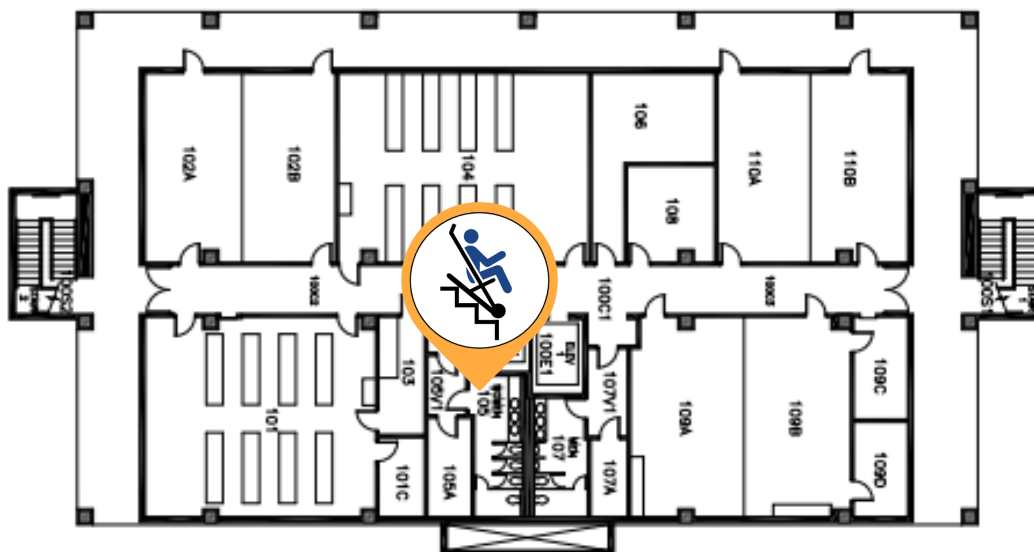

Chair # **CS1**

Location: **Womens restroom 105**

Style: **300-H**



## Dan Black Hall - 2nd Floor

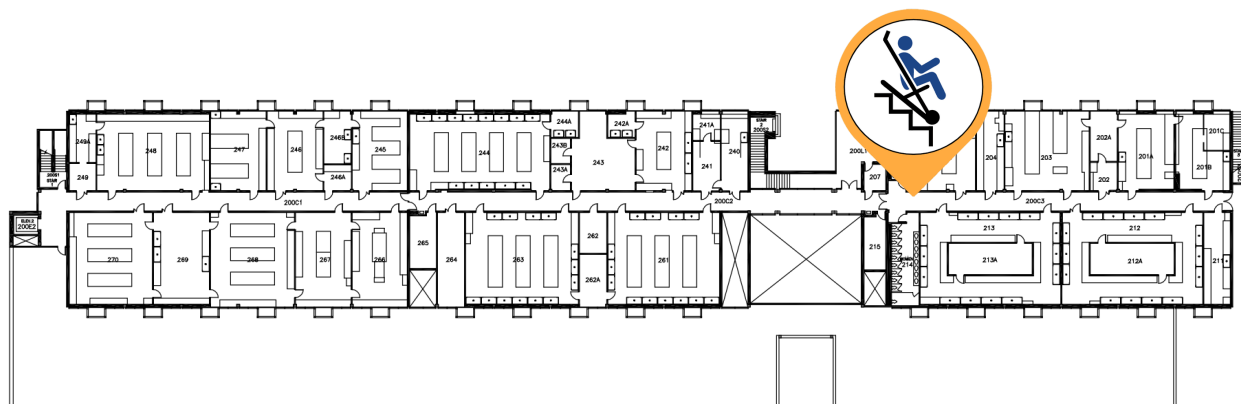

Chair # **DBH 2**

Location: **Stair 1 (across from elevator)**

Style: **300-H**





## Education Classroom - Basement



Chair # **EC 1**

Location: **Southwest stairway**

Style: **300-H**



### Education Classroom - 4th Floor



Chair # **EC2**

Location: **Across from 401**

Style: **300-H**



### Engineering - 1st Floor.

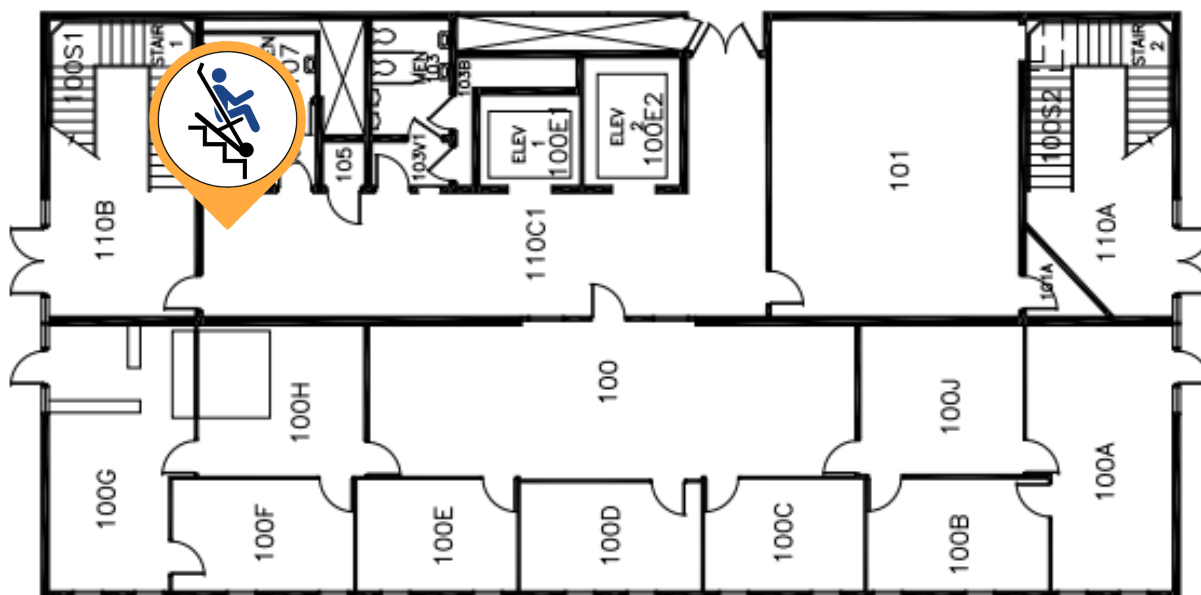

Chair # **ENG1**

Location: **North stairway**

Style: **300-H**

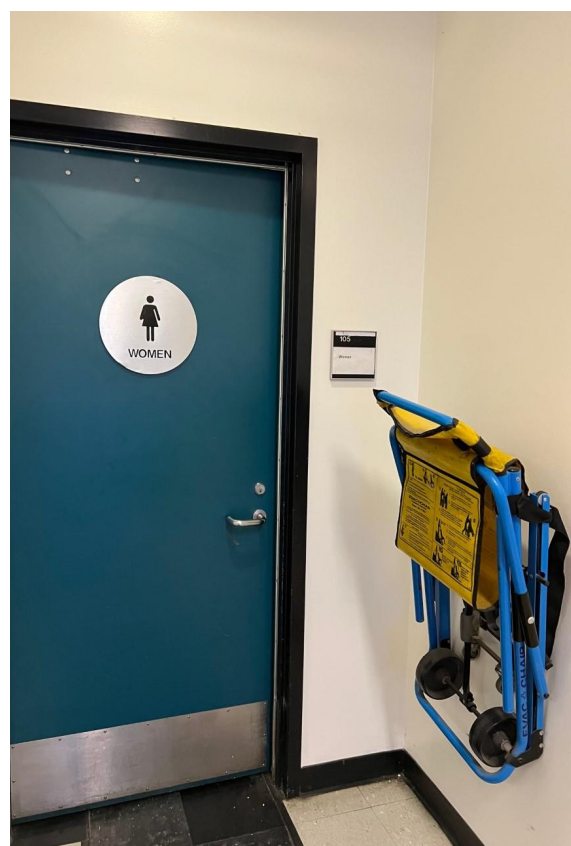

### Golleher Alumni House - 2nd Floor

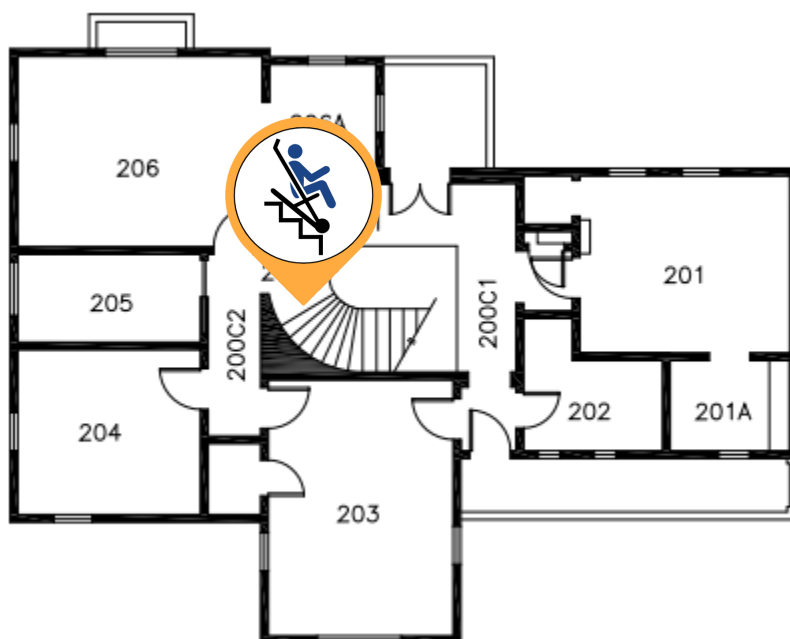

Chair # **GH1**

Location: **In room 205, up center stairs**

Style: **300-H**





## Humanities - 3rd Floor



Chair # **HSS2**

Location: **East stairs by 329**

Style: **300-H**



## Humanities - 6th Floor

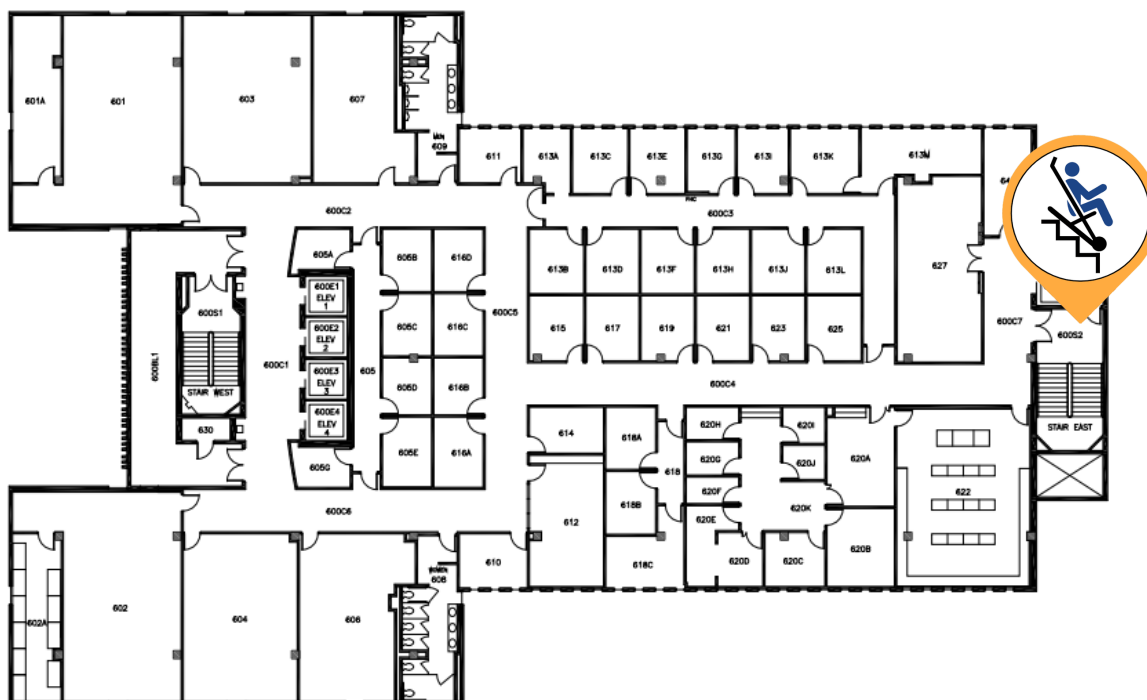

Chair # **HSS1**

Location: **East stairs by 629**

Style: **300-H**

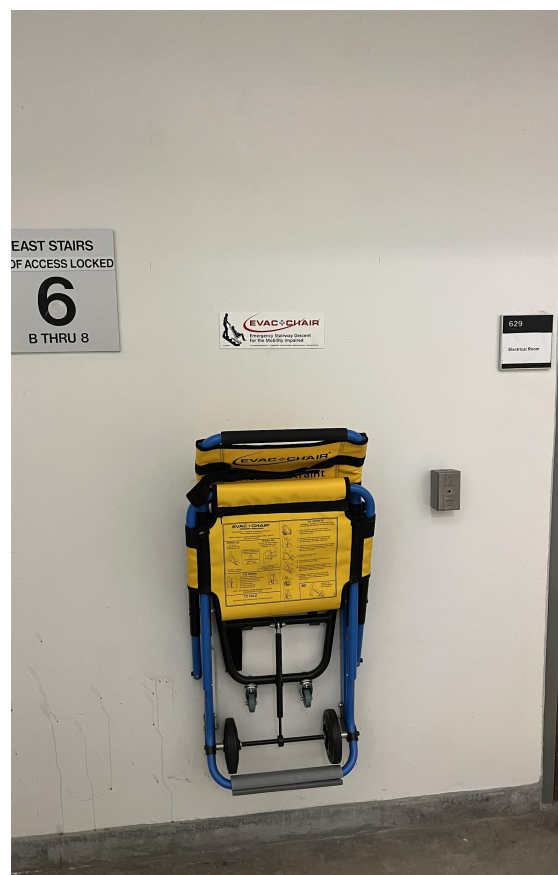

## Kinesiology - Basement

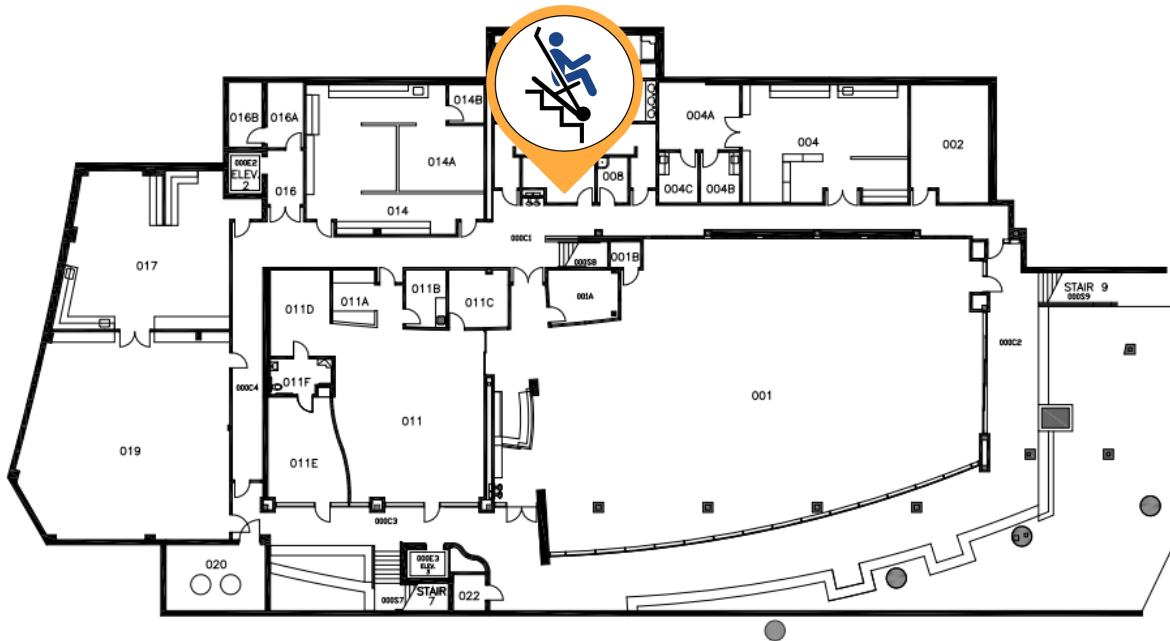

Chair # **KHS1**

Location: **Near room 010**

Style: **IBEX**

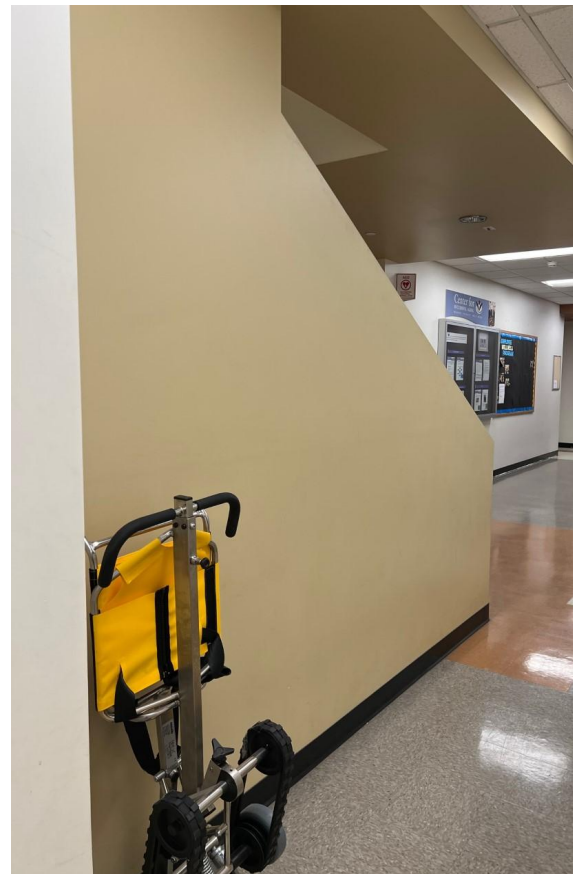

### Kinesiology - 2nd Floor

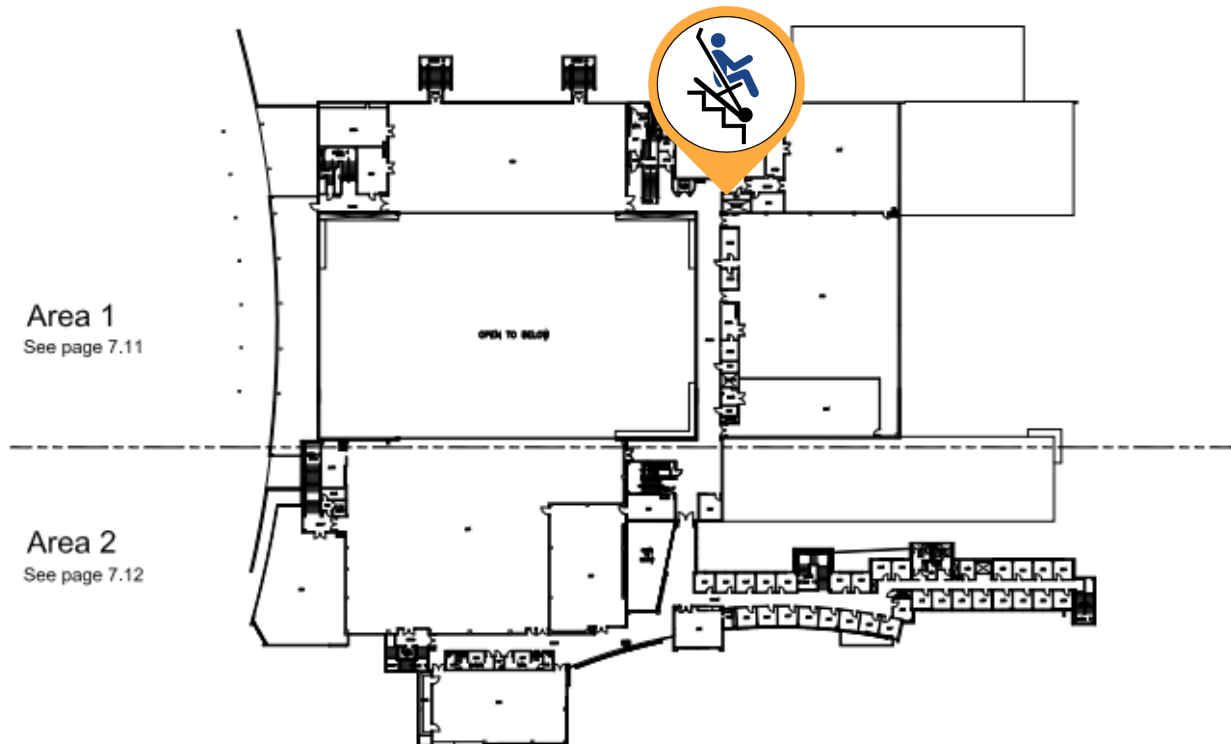

Chair # **KHS2**

Location: **By stairway 3 (near room 260)**

Style: **300-H**

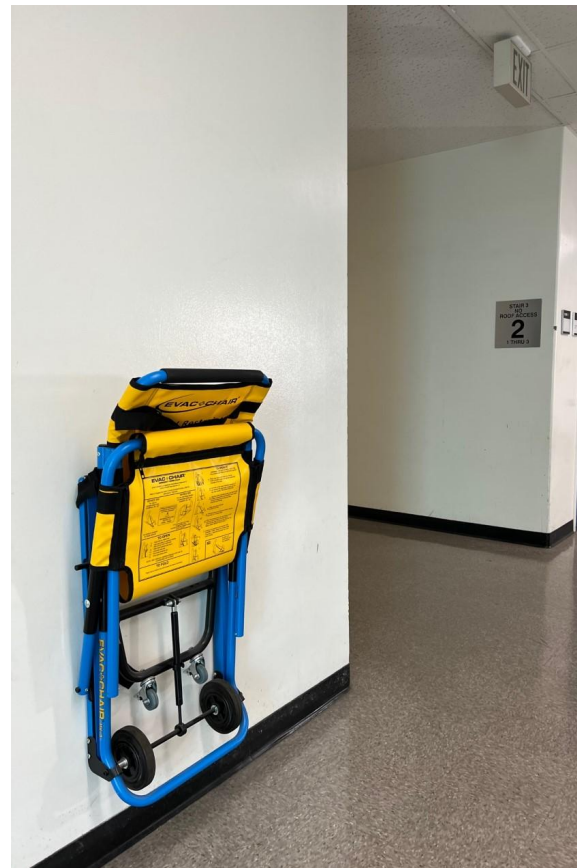



### Langsdorf - 2nd Floor

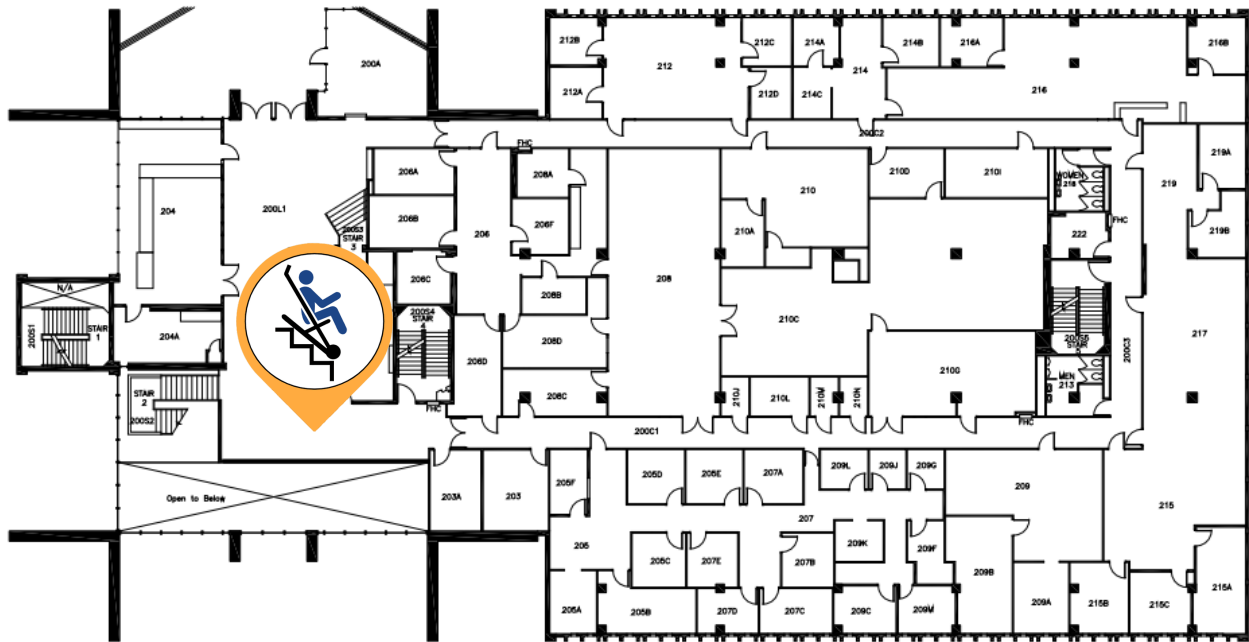

Chair # **LH1**

Location: **South lobby**

Style: **300-H**



### Langsdorf - 5th Floor

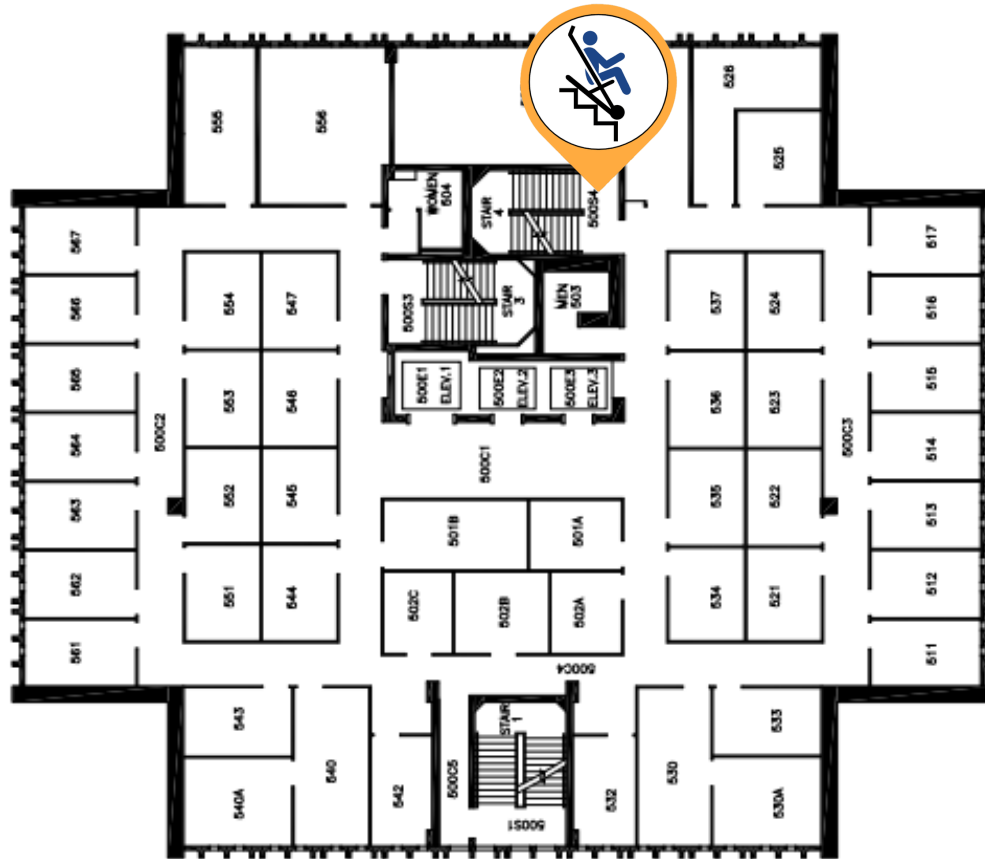

Chair # **LH2**

Location: **West stairs**

Style: **300-H**



### Library North - 1st Floor

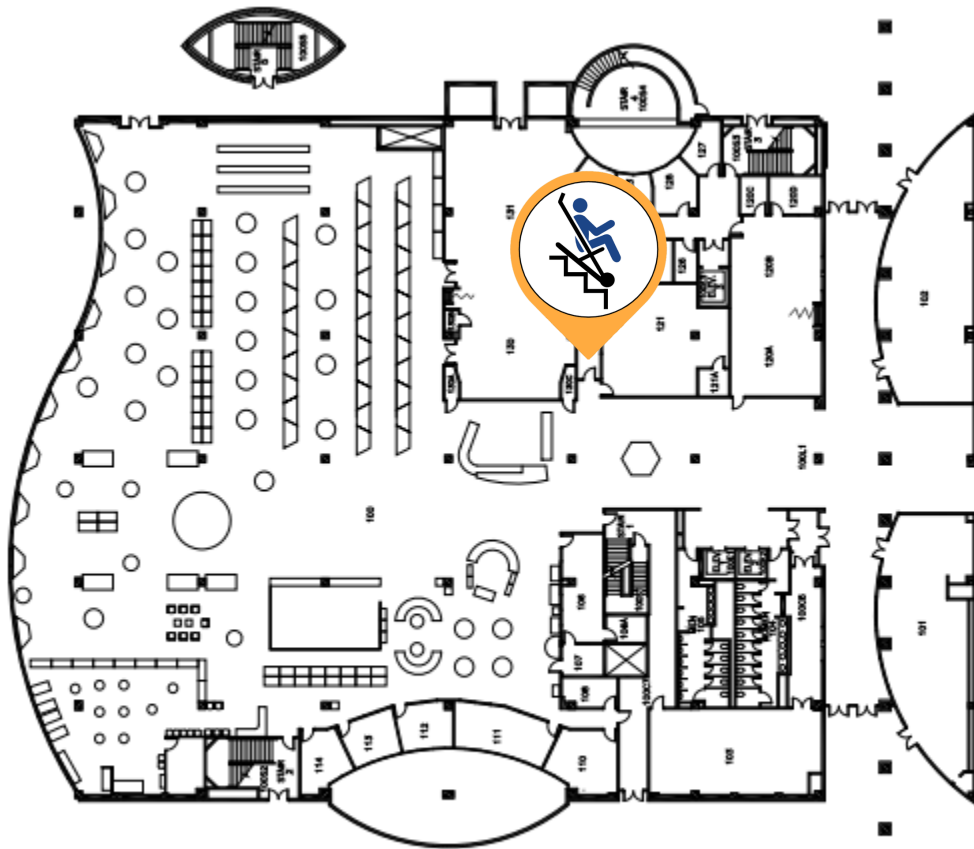

Chair # **PLN1**

Location: **On wall inside staff area**

Style: **300-H**



### Library North - Basement

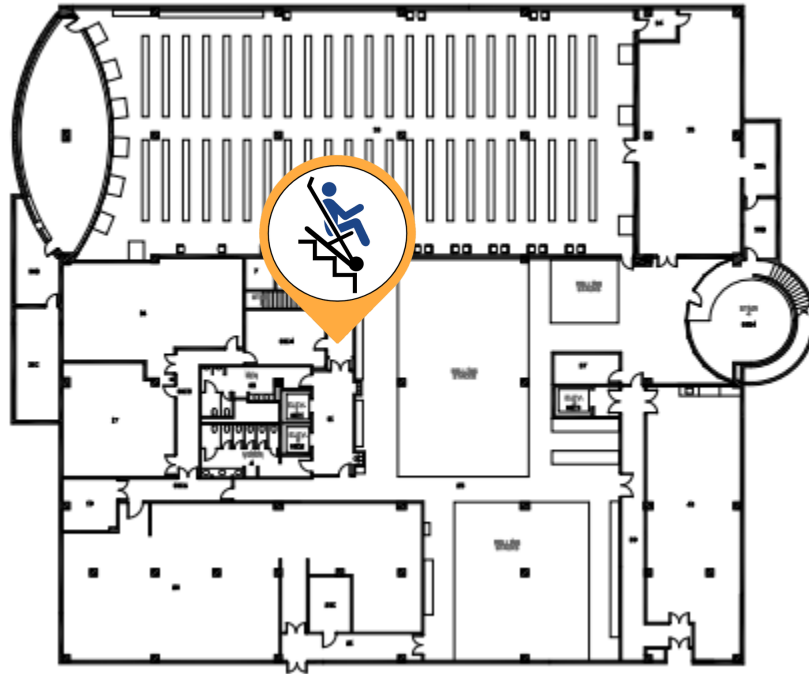

Chair # **PLN2**

Location: **By stairway 1**

Style: **IBEX**





### Library South - 4th Floor

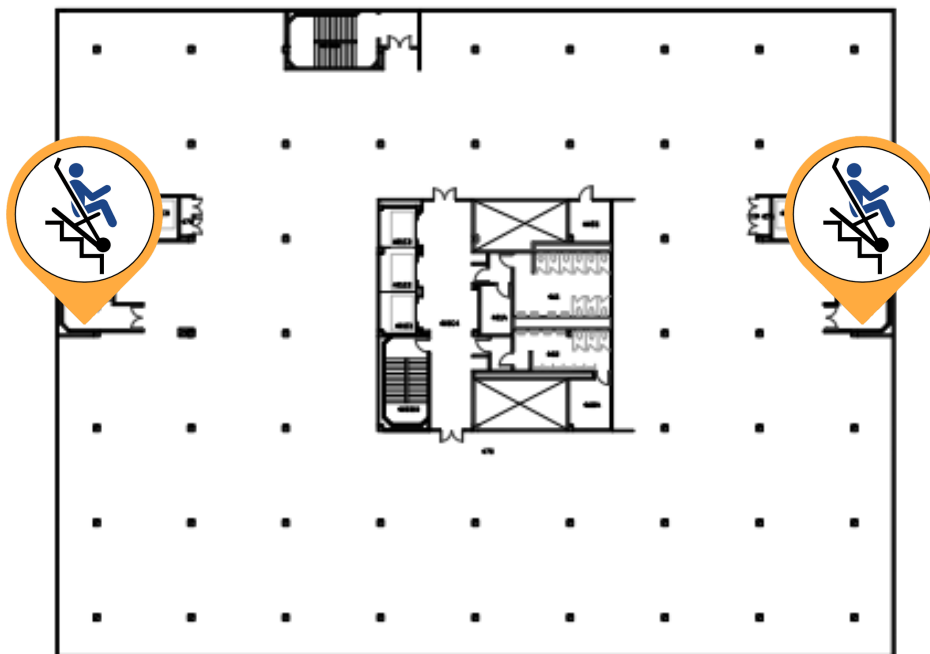

Chair # **PLS2**

Location: **South stairway**

Style: **300-H**



Chair # **PLS1**

Location: **North stairway**

Style: **300-H**



### McCarthy Hall - 3rd Floor

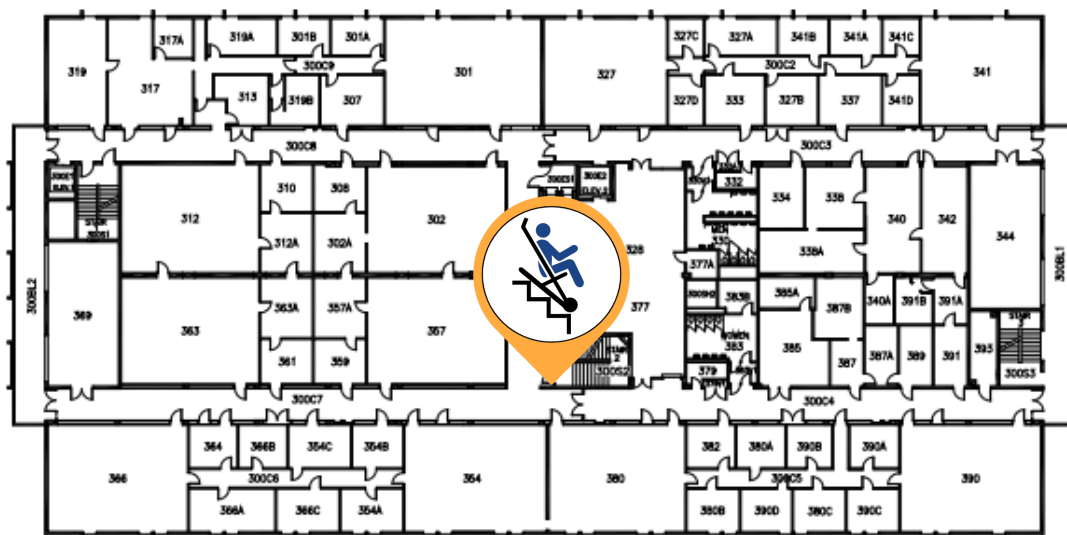

Chair # **MH1**

Location: **By center stairs**

Style: **300-H**

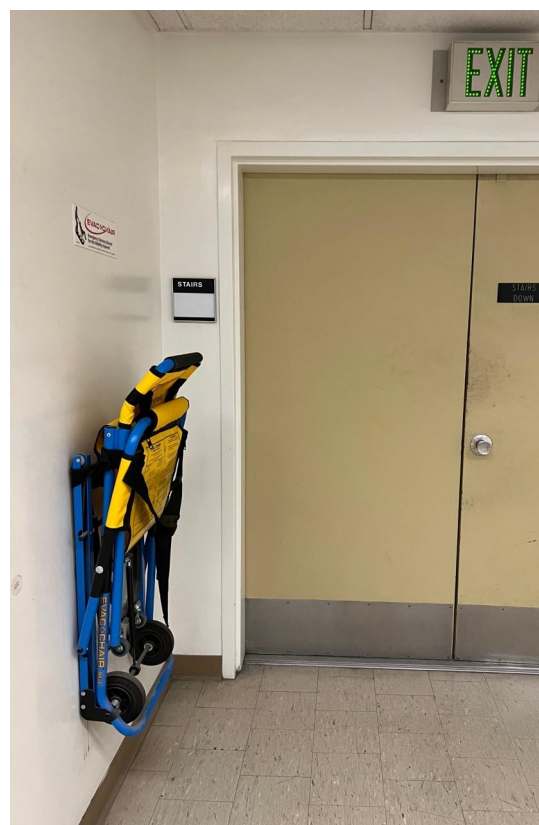

### McCarthy Hall - Basement

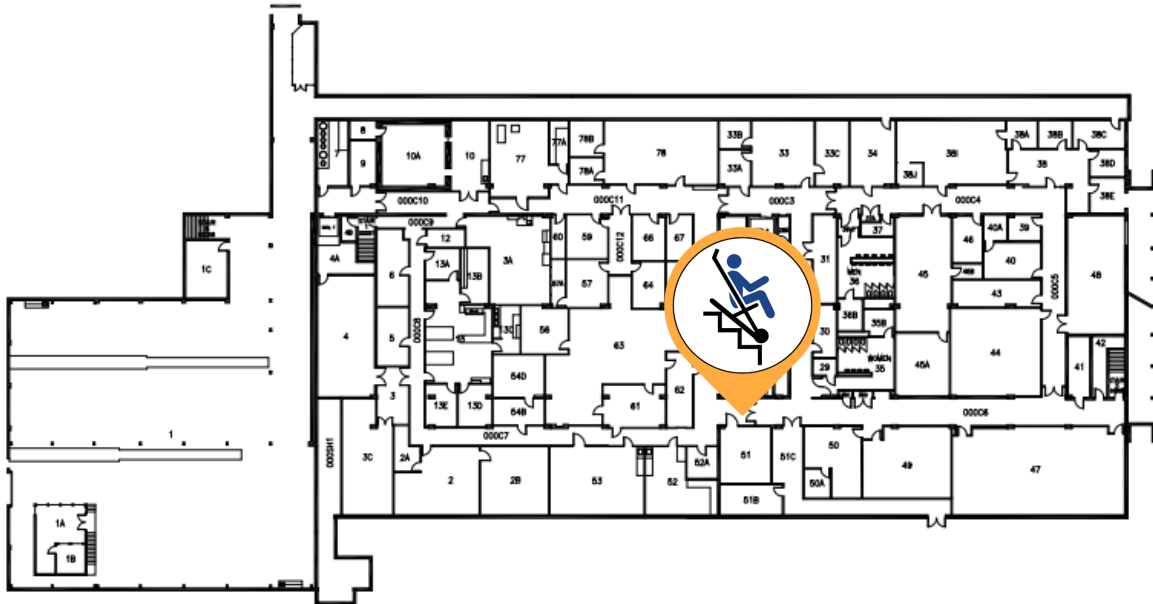

Chair # **MH2**

Location: **By stair 2 (near room 51)**

Style: **IBEX**



## Mihaylo Hall - 2nd Floor

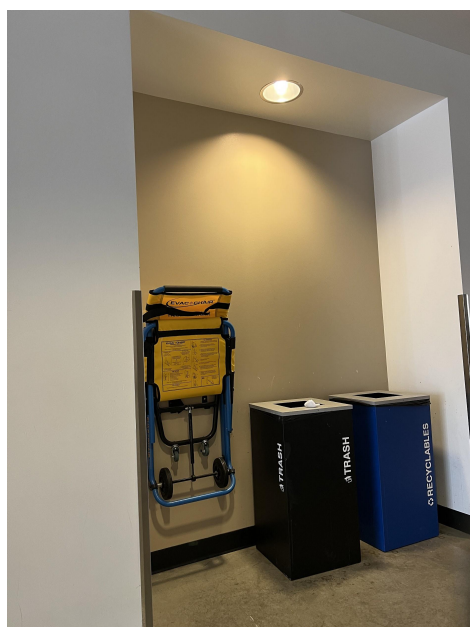
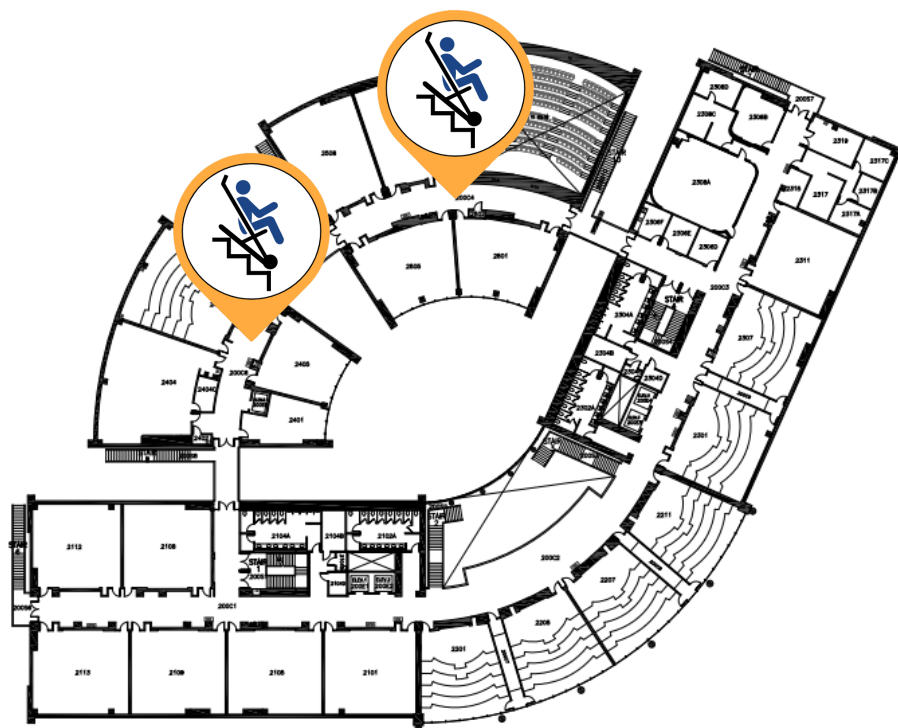

Chair # **SGMH2**  
 Location: **By room 2406**  
 Style: **300-H**



Chair # **SGMH1**  
 Location: **By room 2504**  
 Style: **300-H**





### Mihaylo Hall - 4th Floor

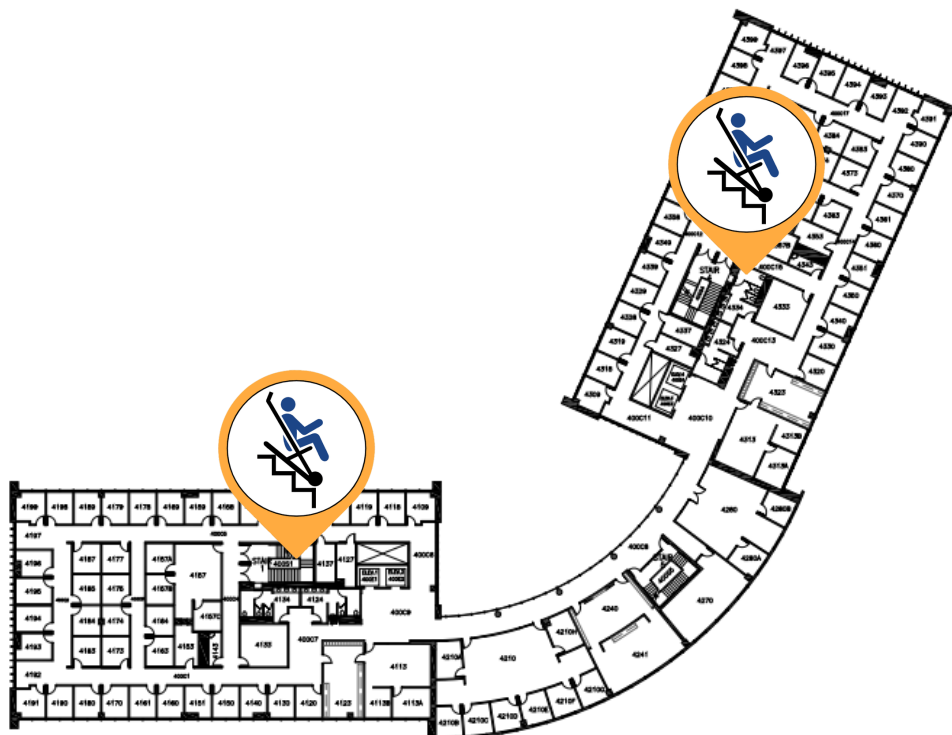

Chair # **SGMH3**

Location: **In stairway 1**

Style: **300-H**



Chair # **SGMH4**

Location: **In stairway 4**

Style: **300-H**



## Performing Arts - 1st Floor

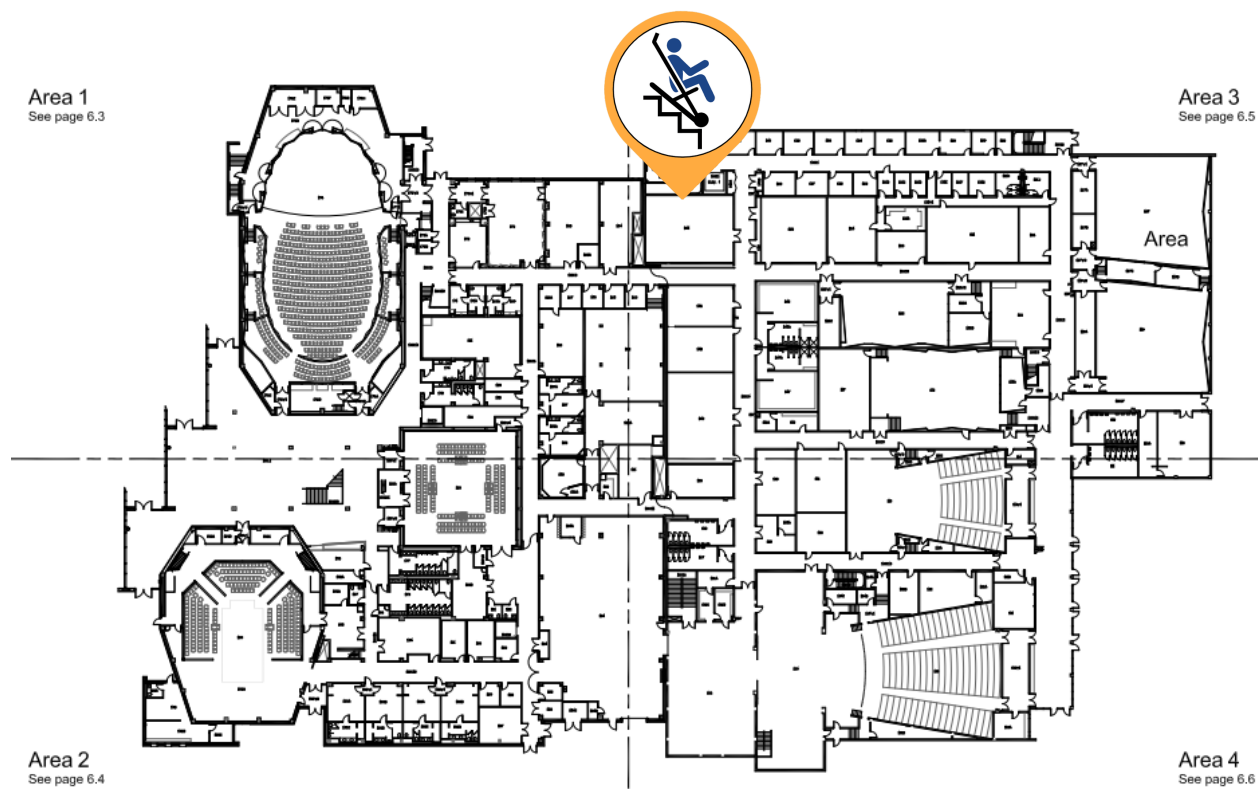

Chair # **CPAC1**

Location: **N entrance/ stair 1/ by room 142**

Style: **300-H**



## Performing Arts - 2nd Floor

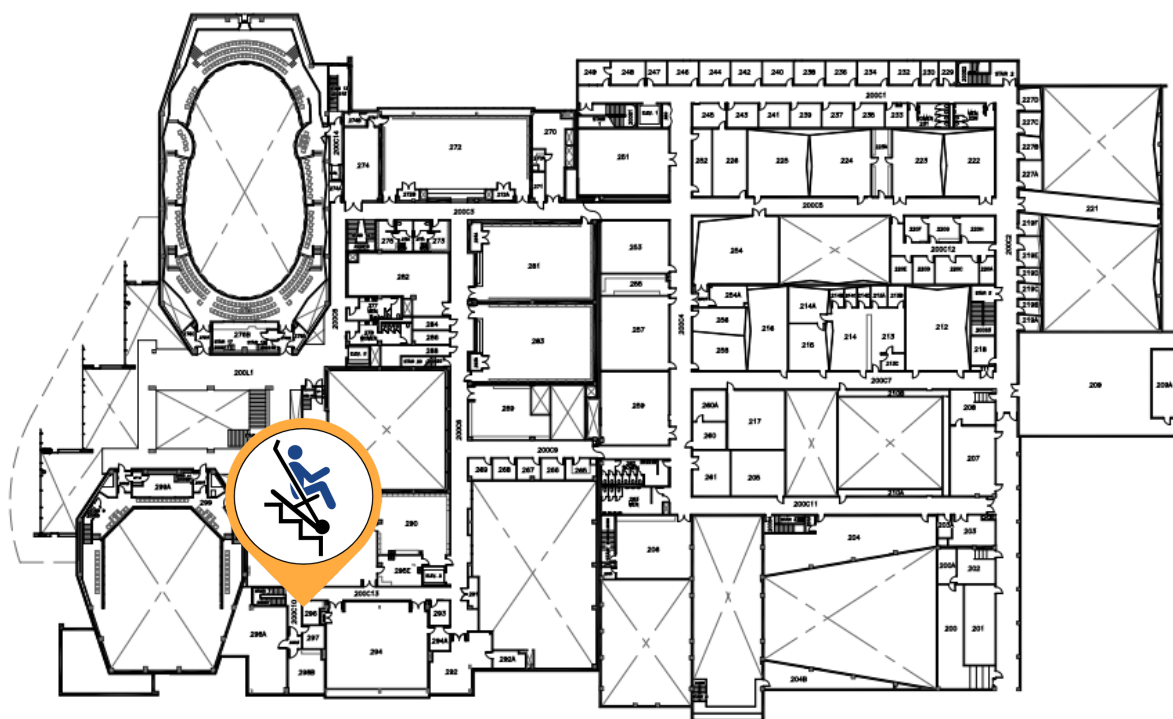

Chair # **CPAC2**

Location: **By stairway 7 (near room 296)**

Style: **300-H**



### Titan Stadium Press Box - 2nd Floor

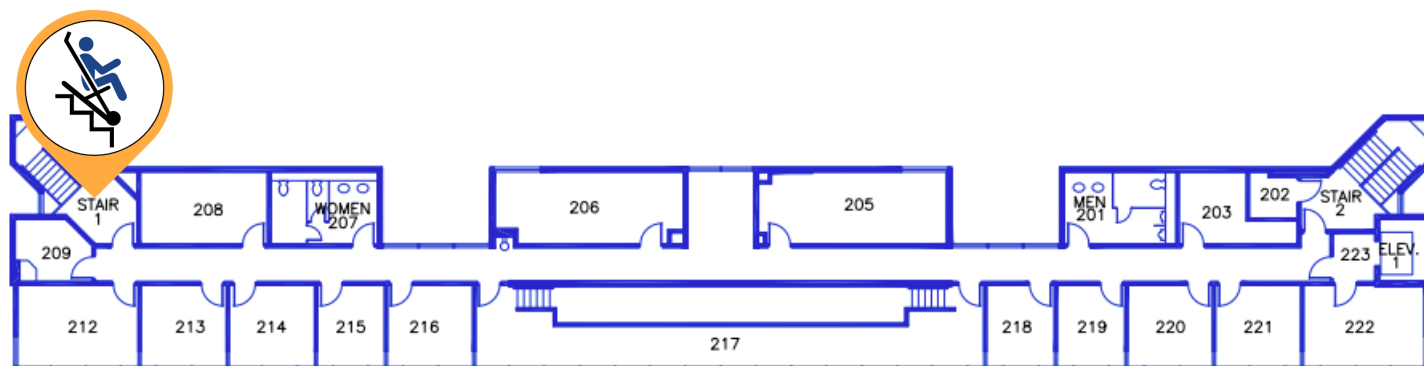

Chair # **TSPB1**

Location: **In stairway 1 (south)**

Style: **300-H**





### Gordon Hall - 3rd Floor

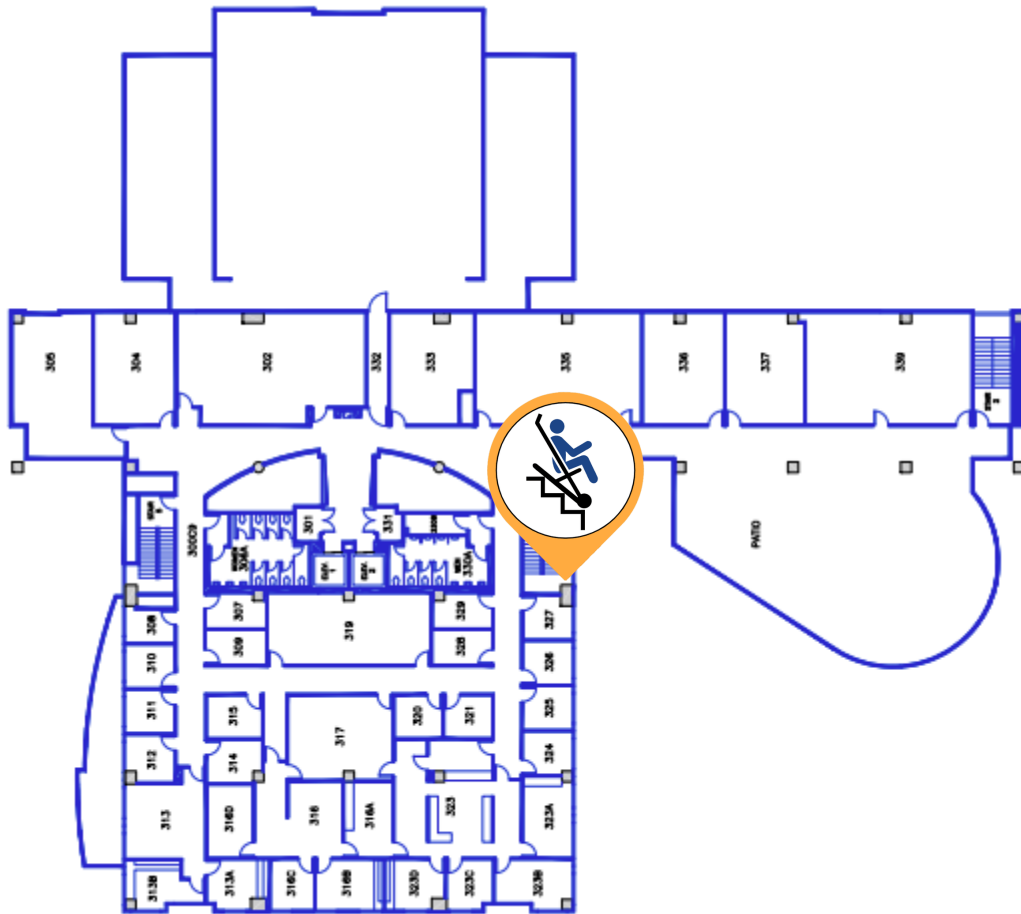

Chair # **UH1**

Location: **South Stairwell**

Style: **300-H**



### Titan House - Basement

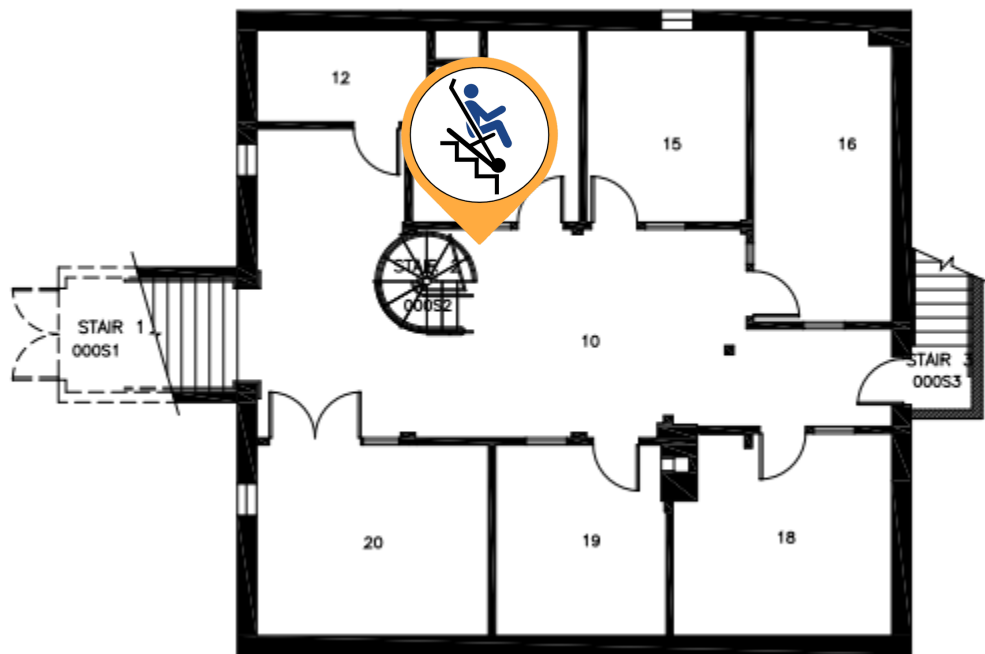

Chair # **TH1**

Location: **Under spiral stairs**

Style: **IBEX**



### Visual Arts Building D - 2nd Floor

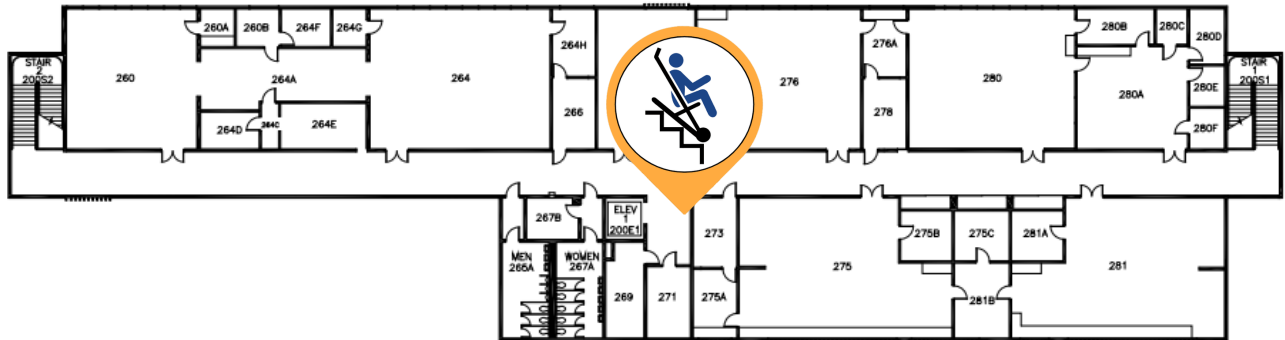

Chair # **VA1**

Location: **Across from elevator**

Style: **300-H**



### Visual Arts Building E - 2nd Floor

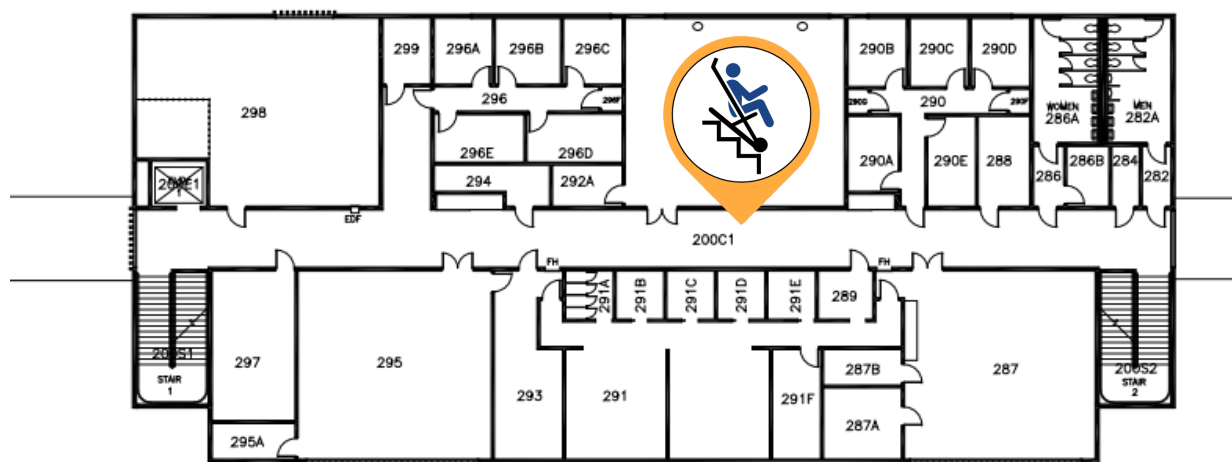

Chair # **VA2**

Location: **Near room 292**

Style: **300-H**

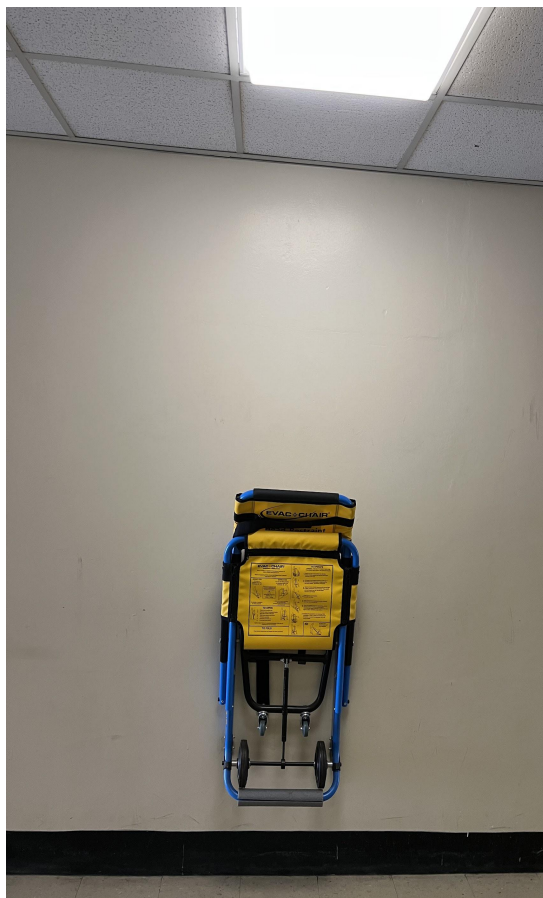



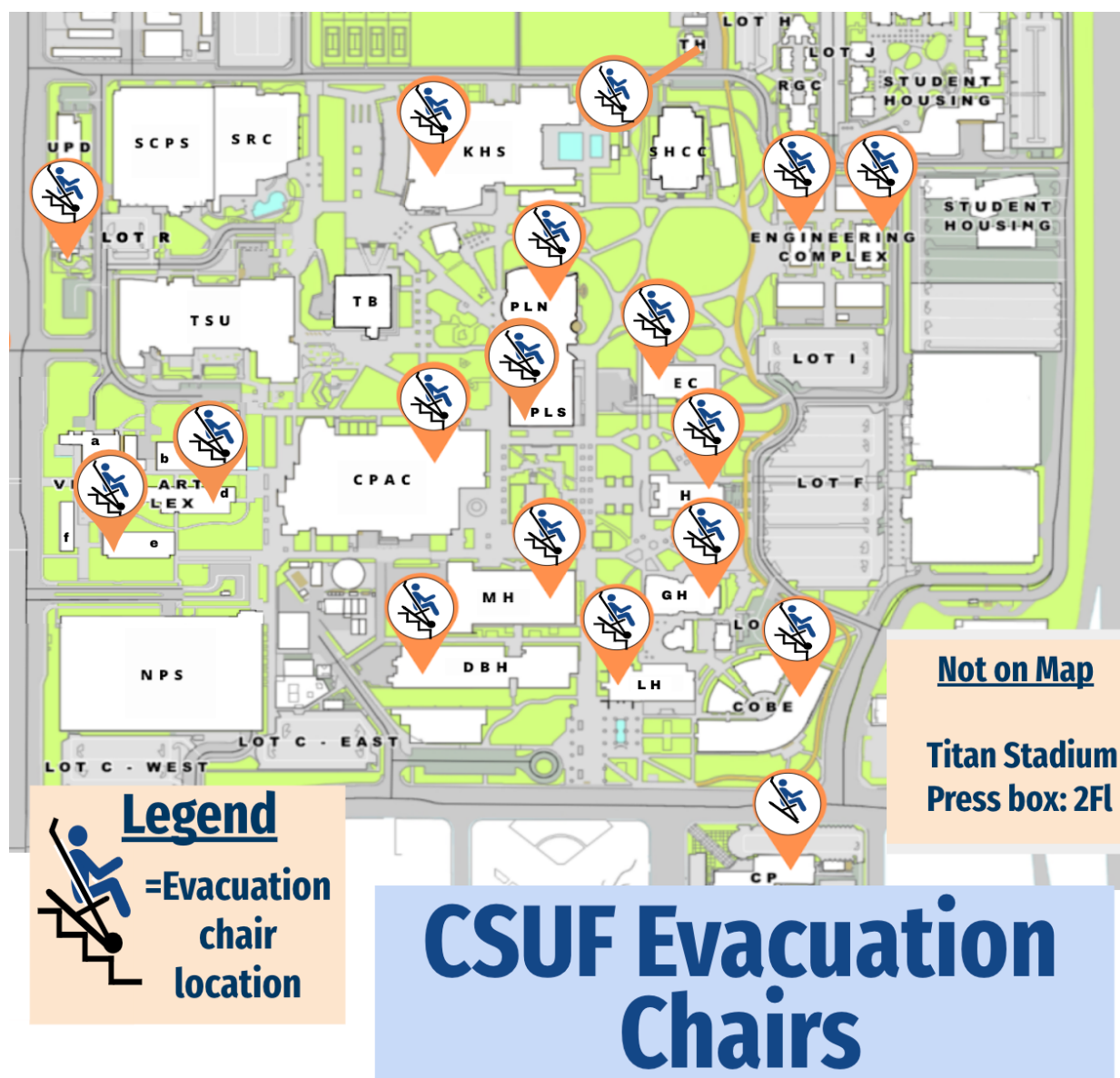

- College of Business and Economics (4): 2Fl\*, 4Fl\*
- College Park (3): 1Fl, 7Fl\*
- Computer Science (1): 1Fl
- Dan Black Hall (2): 2Fl\*
- Education Classroom (2): Basement, 1Fl
- Engineering (1): 1Fl
- Golleher Alumni House (1): 2Fl
- Gordon Hall (1): 3Fl
- Humanities (2): 3Fl, 6Fl
- Kinesiology (2): Basement, 2Fl
- Langsdorf Hall (2): 2Fl, 5Fl
- Library North (2): Basement, 1Fl
- Library South (2): 4Fl\*
- McCarthy Hall (2): Basement, 3Fl
- Performing Arts (2): 1Fl, 2Fl
- Titan House (1): Basement
- Visual Arts (2): 2Fl D 1 / E 1

**Note:** \* = 2 chairs on floor

